



AMF-Bruns

SHORT OPERATION MANUAL

Smartfloor Seat Legs



**SHORT
OPERATION
MANUAL -**
Please read carefully
before using, and
keep ready to hand
inside your vehicle.





How to move or remove Smartfloor seat legs

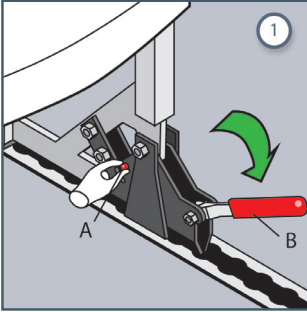

Removing seat legs

1. Hold security bolt (A) in upper position whilst pressing down the handle (B) to release the seat leg. Repeat this procedure on the other side. Now the seat can be moved within the track, or removed.

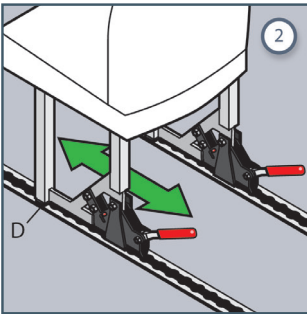

Fixing seat legs

2. Tilt seat slightly forward onto seat legs (D) to make seat slide into desired position.*

** Seat legs with spigots at the front:
The spigot must be positioned in a hole.*

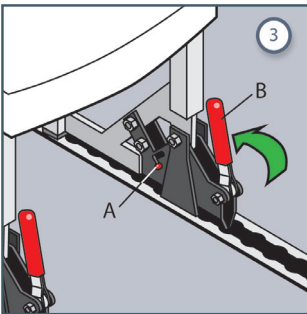

3. The handles (B) fix the seat in its new position. The security bolts (A) have to be in lower position. Please repeat this procedure with the other seat leg to fix the seat.



AMF-Brunns GmbH & Co. KG

Hauptstraße 101 | 26689 Apen | Germany

Phone (Sale) +49 (0) 44 89 / 72 72 50

Phone (Service) +49 (0) 44 89 / 72 72 37

Fax +49 (0) 44 89 / 62 45

hubmatik@amf-bruns.de | www.amf-bruns.de